

1 2 3 4 5 6 7 8

REV	LOCATIONS	DESCRIPTION	DATE	REVISER	APPD

A

B

C

D

E

F

Notes:

- Material: Copper
- Insulator: PVC (UL 94V-0)
- Plating: Matte tin plated
- Wire range: 2.5~4mm<sup>2</sup>/ (14~12AWG)
- Applicable screw: #8 UNC
- Temperature Range-Operating: 0°C~75°C
- Maximum electrical rating: 600V
- Max current: 37A

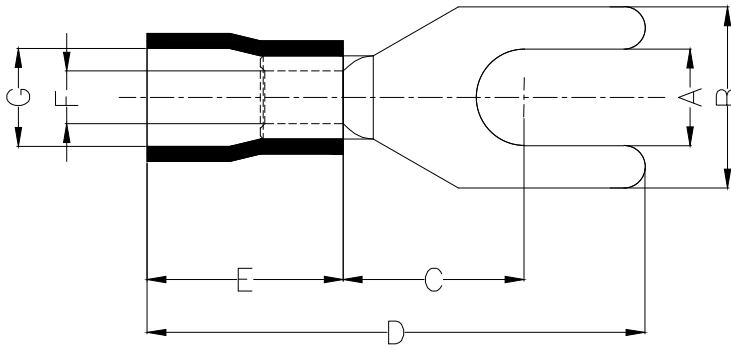
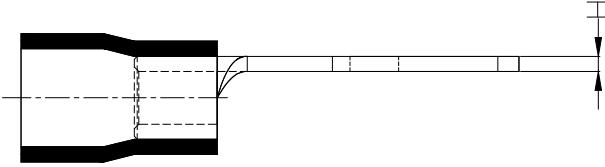

Dimensions							
A	B	C	D	E	F	G	H
±0.3	±0.5	±1	±1	±1	±0.5	±0.5	±0.05
4.3	8.0	7.7	25.3	13.0	2.9	6.2	1.0

PART NO.	Color Of Insulator
FYT02-003500400ARD2	Red
FYT02-003500400ABU2	Blue
FYT02-003500400ABK2	Black

THIRD ANGLE PROJECTION

DESIGN UNITS METRIC(mm)

SCALE 5:1    SIZE A4

GENERAL TOLERANCES (UNLESS SPECIFIED)	
X. ±0.30	X.* ±5'
X.X ±0.20	X.X' ±2'
X.XX ±0.15	X.XX' ±1'
X.PYD ±0.10	X.PYD' ±0.5'

APPROVE BY	DATE
LEO	10/JAN/21
CHECKED BY	DATE
GISELLE	10/JAN/21
DRAWN BY	DATE
PYD	10/JAN/21

PART NO.	ITEM NO.
FYT02-003500400AXX2	FYT02
TITLE	
Spade tongue terminal	

Building Technology Cornerstone

REV 0    SHEET NO. 1/1

THIS DRAWING CONTAINS INFORMATION THAT IS PROPRIETARY TO TXGA INDUSTRIAL ELECTRONICS(S.Z)CO.,LTD AND SHOULD NOT BE USED WITHOUT WRITTEN PERMISSION

1 2 3 4 5 6 7 8